



Quantum® Hardcoated Polycarbonate  
 VStream® Windscreen  
 Z2474 and Z2475 for F700GS

Thank you for purchasing a ZTechnik product. Read these instructions carefully and thoroughly before beginning work. Dealers, if installing this windscreen for a customer, please give them this manual. It contains information needed to properly maintain and use this product.



**Attention:**

Special notes and cautionary measures which can prevent damage to the accessory or motorcycle.



**Note:**

Tips for facilitation of operation, control and adjustment, as well as maintenance work.

**CONTENTS OF KIT (Refer to Page 3)**

Item	Description	Part No.	Qty.	Notes, Tools
<b>Refer to Figure 1, Page 3</b>				
1	VStream® Windscreen		1	
2	Deflector, Left	20-290330-000	1	
3	Deflector, Right	20-290331-000	1	
<b>BAG# 1106</b>				
<b>Refer to Figure 2, Page 3</b>				
4	Bushing, Outer	49-495263-000	2	
5	Bushing, Inner	49-495264-000	2	
6	Nut, M5, Acorn	42-483013-000	4	5mm Hex Wrench; Box Wrench with Tape
7	Grommet	44-447350-000	4	
8	Washer, Flat	49-490105-000	4	
9	Screw, M5 X 35mm, Outer	51-514126-000	2	5mm Hex Wrench
10	Screw, M5 X 30mm, Inner	51-514124-000	2	5mm Hex Wrench
11	Cap, Black Aluminum	34-346048-000	4	
<b>Refer to Figure 3, Page 3</b>				
12	Washer, Poron	44-447635-000	6	
13	Screw, M5 x 12mm	51-514123-000	6	5mm Hex Wrench
14	Screw, M5 x 40mm	51-514125-000	2	5mm Hex Wrench, Side Deflector to Tank Cover
15	Cap, Black, Delrin	34-346049-000	8	
16	Nut, Captive	49-495265-000	6	
17	Bushing, Support	49-495266-000	2	
<b>Refer to Figure 4, Page 3</b>				
18	Bracket, Support, Left	37-370882-000	1	T25 Torx (for removal of stock screw); 5mm Hex
19	Bracket, Support, Right	37-370883-000	1	T25 Torx (for removal of stock screw); 5mm Hex

VStream® windscreen patent no. 7,387,328

ZTechnik PO Box 158 Maywood, IL 60153-0158 USA

708-343-0400 / Fax: 708-343-0625 / www.ztechnik.com / e-mail: info@ztechnik.com



Ask for Shield Wash™ and RainZip® at your local dealer or visit [www.ztechnik.com](http://www.ztechnik.com).

## CLEANING AND MAINTENANCE

To clean the screen, wash with a clean soft cloth, plenty of warm water and if necessary, a non-abrasive soap such as dishwashing liquid. Flannel or soft chamois make good cleaning cloths. **Paint, glue residue or grease removal:** Moisten cotton with naphtha or turpentine followed by a wash as above. National Cycle **Shield Wash™** (N1401) makes a good daily cleaner and comes with a handy travel size bottle. Shield Wash is safe for all windshields and helmet visors.

Do not clean polycarbonate in hot sun or high temperatures. Do not clean the screen with glass cleaners.

Do not allow brake fluid, alcohol, or strong solvents to contact the screen.

## RAIN REPELLENT

Do not use rain protective products made for automotive glass. We recommend National Cycle's **RainZip®** (N1410) to keep your windshield clear in rainy weather.



Register your windshield online at [www.ZTechnik.com](http://www.ZTechnik.com)

### ZTechnik 3-Year Limited Warranty

ZTechnik hereby warrants to the original registered owner of a ZTechnik polycarbonate windshield for a period of three years from the date of purchase against breakage. This limited warranty is expressly limited to the replacement of the polycarbonate windscreen. This limited warranty does not include scratches, coating failure, cosmetic wear and tear, replacement of hardware, or any consequential damages or expenses including labor cost of installation, removal and/or replacement, inconvenience, inbound freight expenses or damage to any other component of the motorcycle or any other accessories. Certain chemicals, generally known as acidic hydrocarbons, are known to cause polycarbonate damage and will not be covered under this limited warranty. Please refer to the cleaning instructions supplied with all ZTechnik windshields.

Visit [www.ztechnik.com](http://www.ztechnik.com) for further details, or call or write ZTechnik / PO Box 158 / Maywood, IL 60153 / 708-3430400

## ⚠ WARNING

Never ride your motorcycle with loose accessory mounting hardware. Check the hardware for tightness regularly.

Today's motorcycles are built with enough frame rigidity to withstand the moderate loads imposed on them by the foreseeable addition of an accessory(ies). If an accessory(ies) adversely affects your motorcycle's stability, immediately remove the accessory(ies). Do not ride a motorcycle that exhibits unsafe handling traits.

Have experienced service personnel correct any problem before riding with the accessory(ies) installed. For further questions concerning handling problems associated with an accessory(ies), contact your dealer, motorcycle manufacturer, or accessory manufacturer.

Sunlight reflected off the inside curvature of the windscreen can, at certain times of day, cause extreme heat buildup on the motorcycle's instruments and possibly even melt them. Exercise care in parking to avoid this. Park your motorcycle facing the sun or place an opaque object over this area.

ZTechnik PO Box 158 Maywood, IL 60153-0158 USA

708-343-0400 / Fax: 708-343-0625 / [www.ztechnik.com](http://www.ztechnik.com) / e-mail: [info@ztechnik.com](mailto:info@ztechnik.com)

**PART IDENTIFICATION**

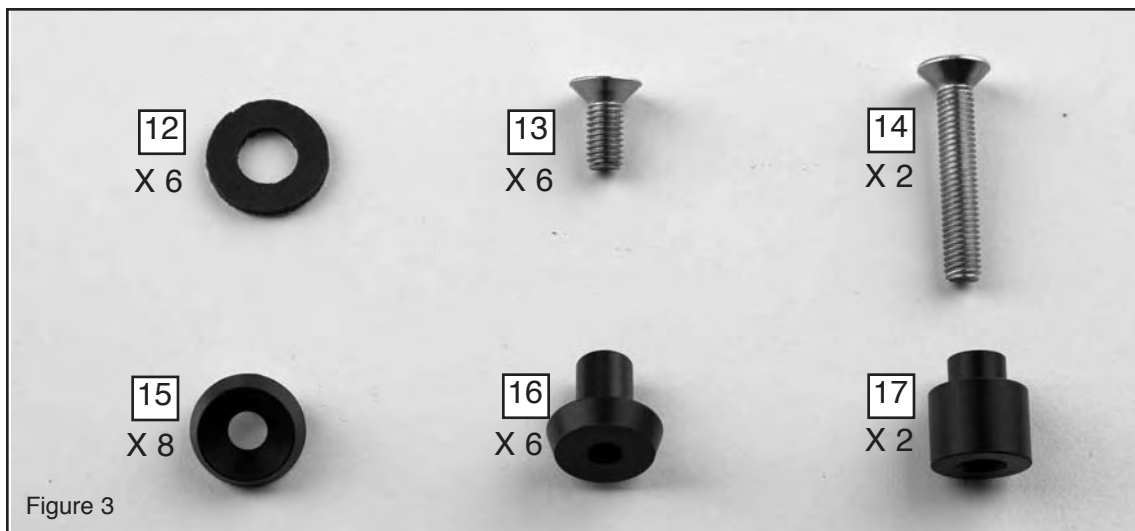
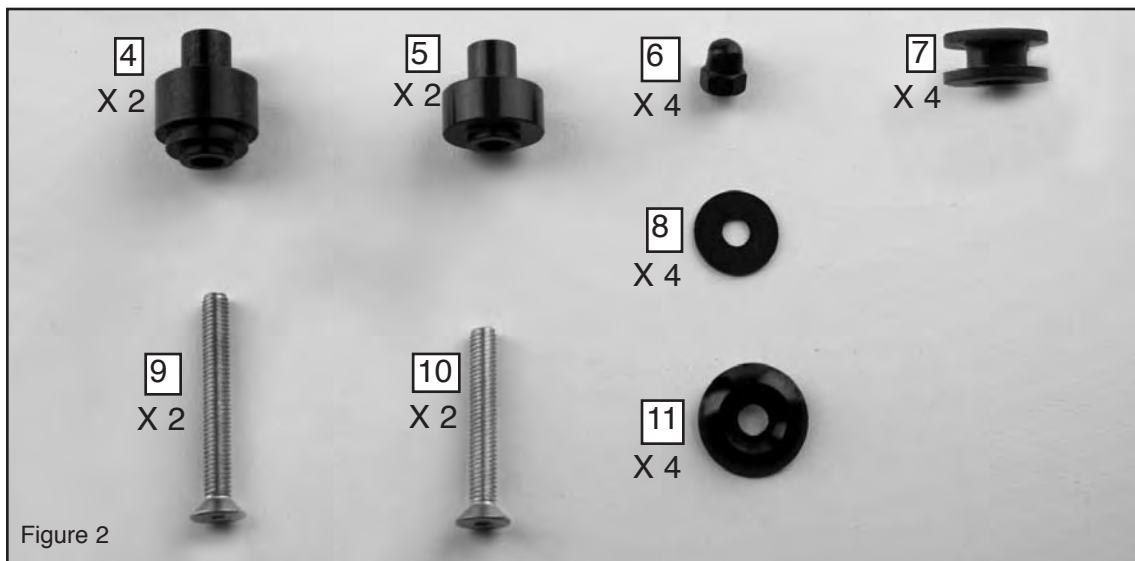
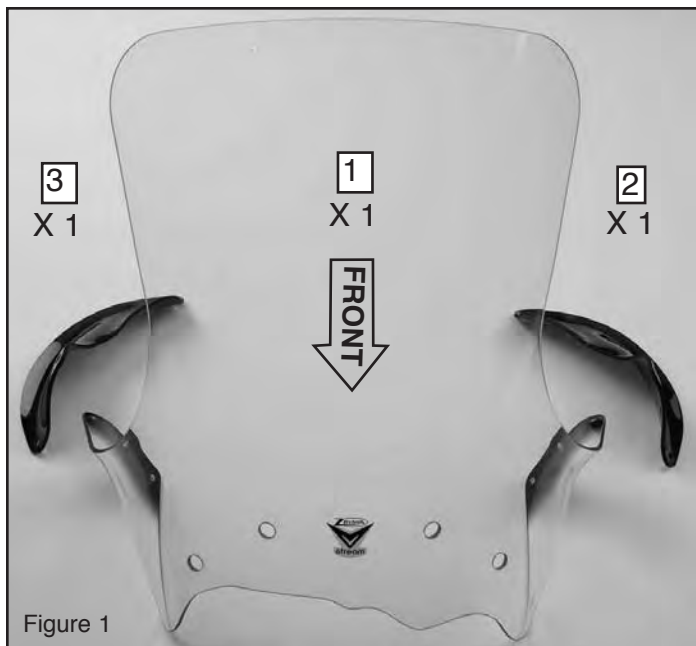

**ZTechnik** PO Box 158 Maywood, IL 60153-0158 USA

708-343-0400 / Fax: 708-343-0625 / [www.ztechnik.com](http://www.ztechnik.com) / e-mail: [info@ztechnik.com](mailto:info@ztechnik.com)

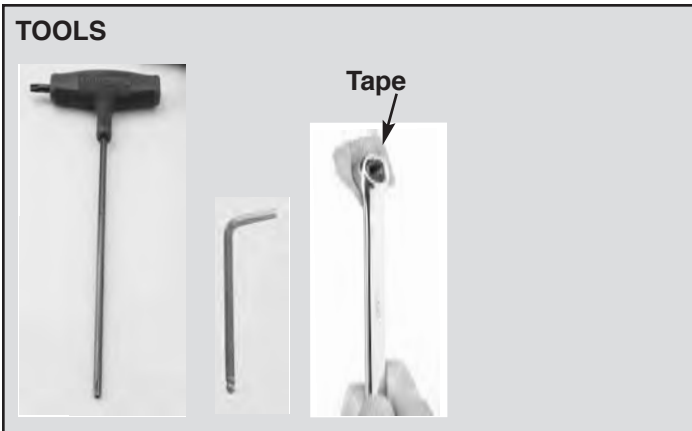

Figure 5

**TOOLS, Figure 5**

- T-25 Torx
- 5mm Hex Wrench
- 5mm Closed Box Wrench
- Tape



**Tape on end of Closed Box Wrench will hold nut (6) in place during installation.**

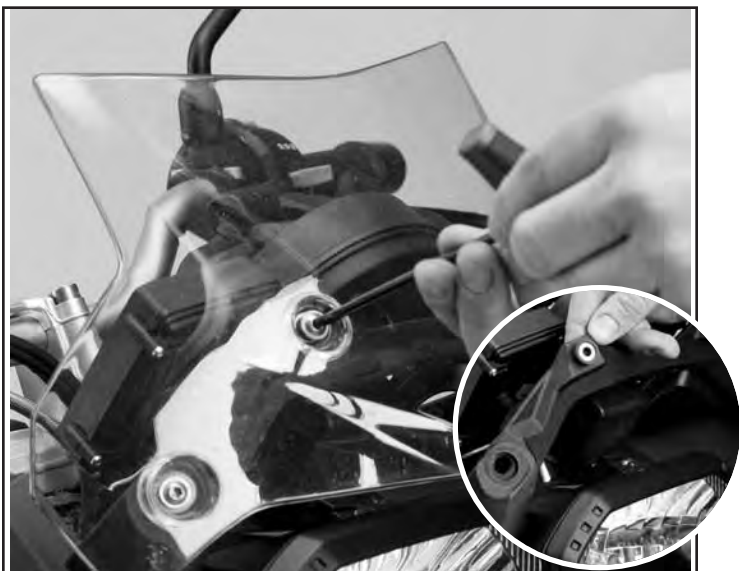

Figure 6

**PREPARATION**

1. Place motorcycle securely on its centerstand.
2. Remove the stock windscreen. Hardware will not be re-used. **Figure 6 (T25 Torx)**



Figure 7

3. Remove the two BMW Oval Head Screws (63 137 655 661) and the two BMW Plastic Washers (46 637 714 241) from the Tank Cover. **This hardware will not be re-used. Figure 7 and Diagram a (T25 Torx)**

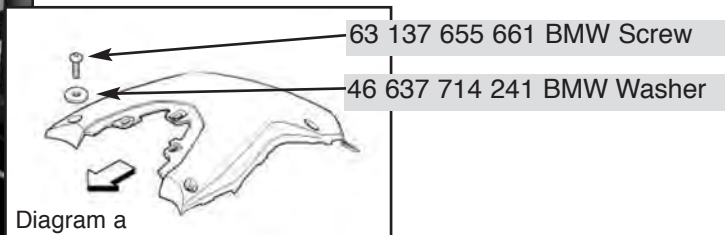

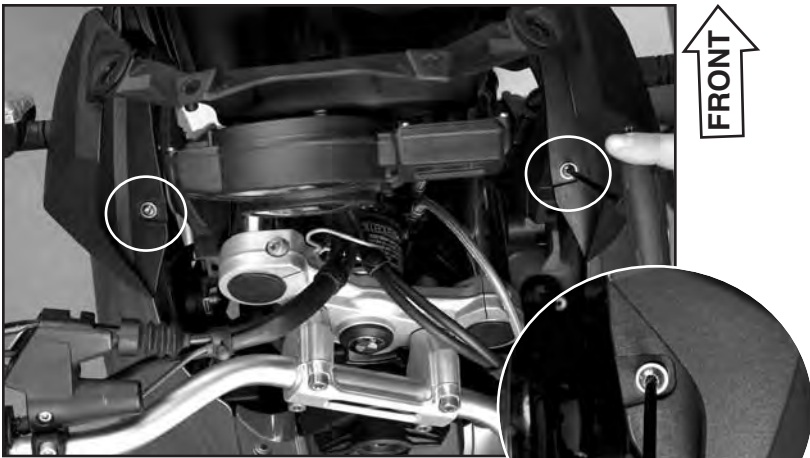

Figure 8

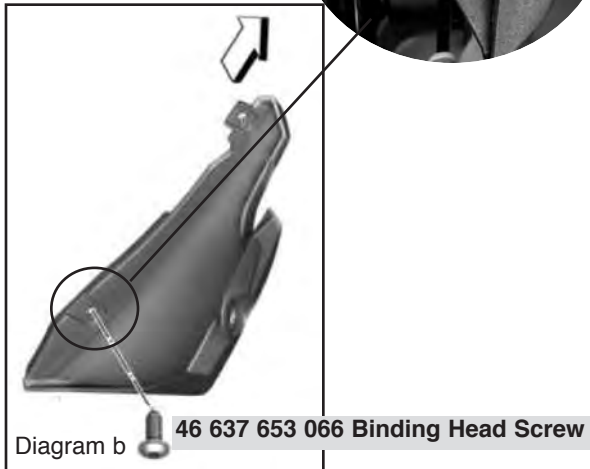

Diagram b

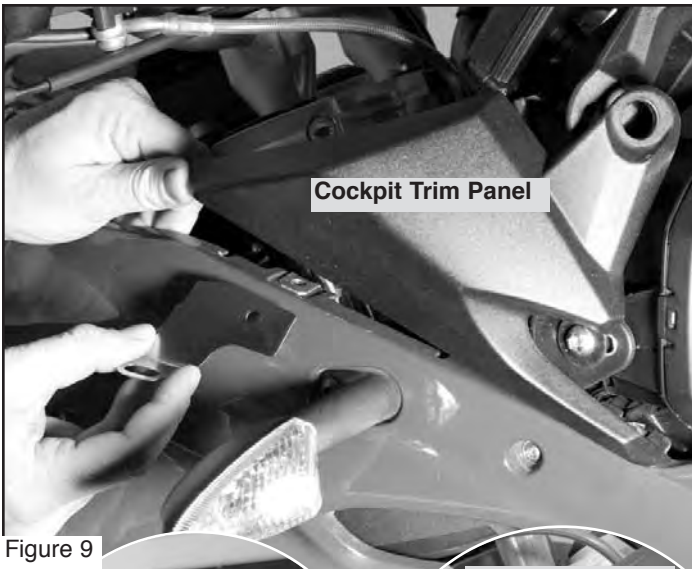
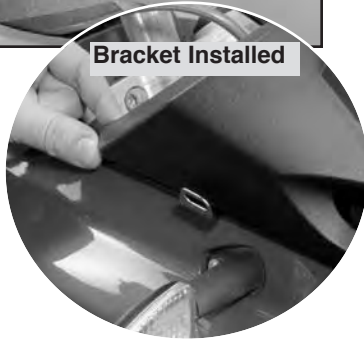
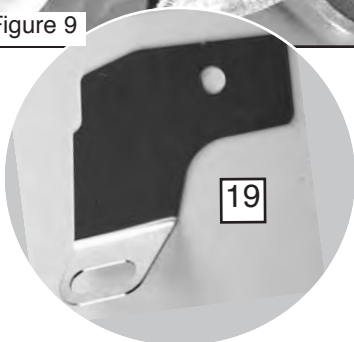

Figure 9



## INSTALLATION

### Install Brackets to Motorcycle

1. Remove the right BMW Binding Head Screw (46 637 653 066) from Cockpit Trim Panel. **Figure 8 and Diagram b (T25 Torx)**

2. Place Right Bracket (19) between Fairing Body and Cockpit Trim Panel. Secure with original Binding Head Screw. **Do not fully tighten at this time. Binding Head Screws will be fully tightened in the last step. Figure 9 (T25 Torx)**

3. Repeat procedure on Left side of motorcycle.

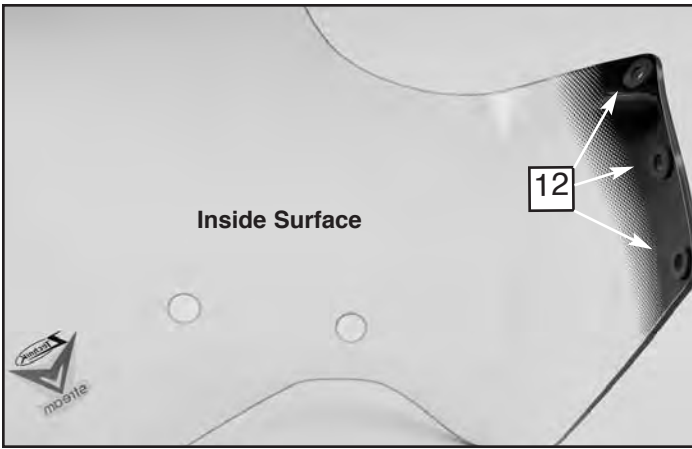

Figure 10

## INSTALLATION

### Install Side Deflectors

4. To the **inside** of the **windscreen** install one Poron Washer (12) around each hole where the Side Deflector will mount. **Figure 10**

5. Install the Right Side Deflector at the **top two** holes as shown in figure 11. **Tighten fully.** **Figure 11 (5mm Hex Wrench)**

6. Repeat procedure for Left Side Deflector. **Figure 11 (5mm Hex Wrench)**

7. Install one Grommet (7) into each wind-screen mount hole. **Figure 12**

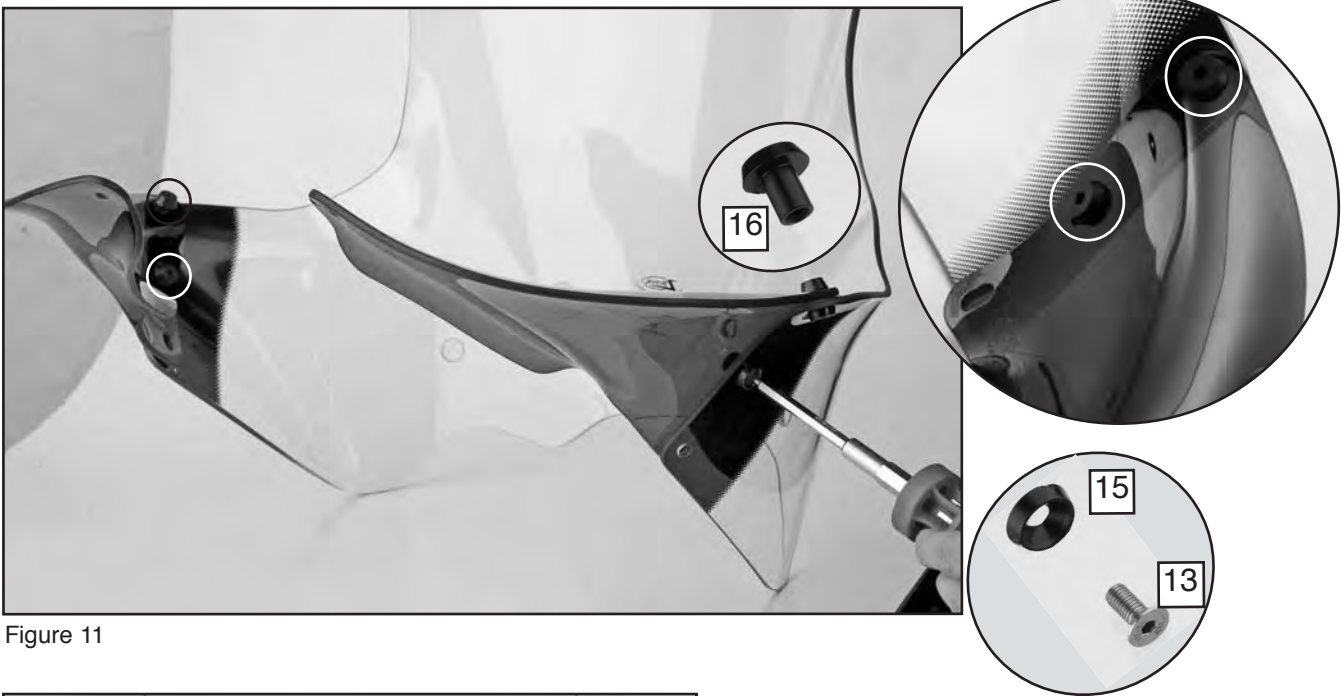

Figure 11

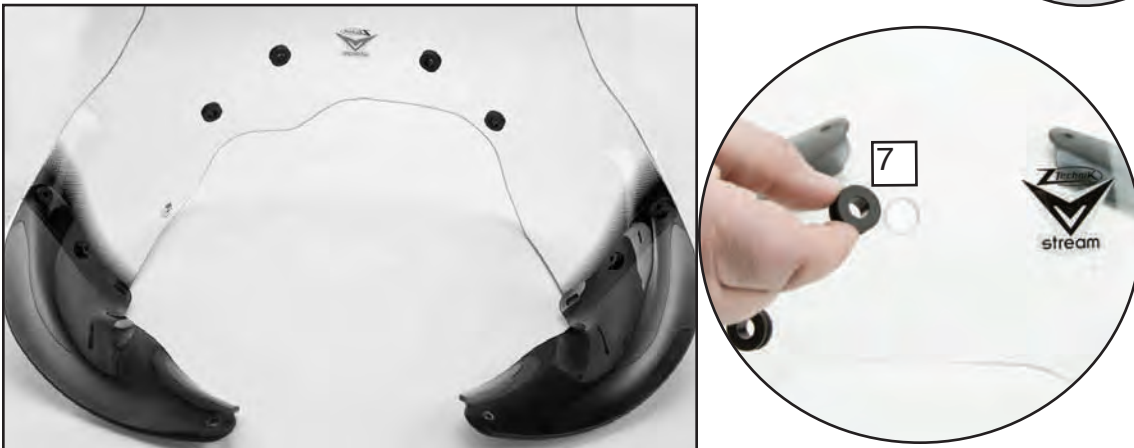

Figure 12

**ZTechnik** PO Box 158 Maywood, IL 60153-0158 USA

708-343-0400 / Fax: 708-343-0625 / [www.ztechnik.com](http://www.ztechnik.com) / e-mail: [info@ztechnik.com](mailto:info@ztechnik.com)

## INSTALLATION

### Install Windshield to Motorcycle

8. From inside of windscreen install the two, Outer Bushings (4) and the two, Inner Bushings (5). **Figure 13**

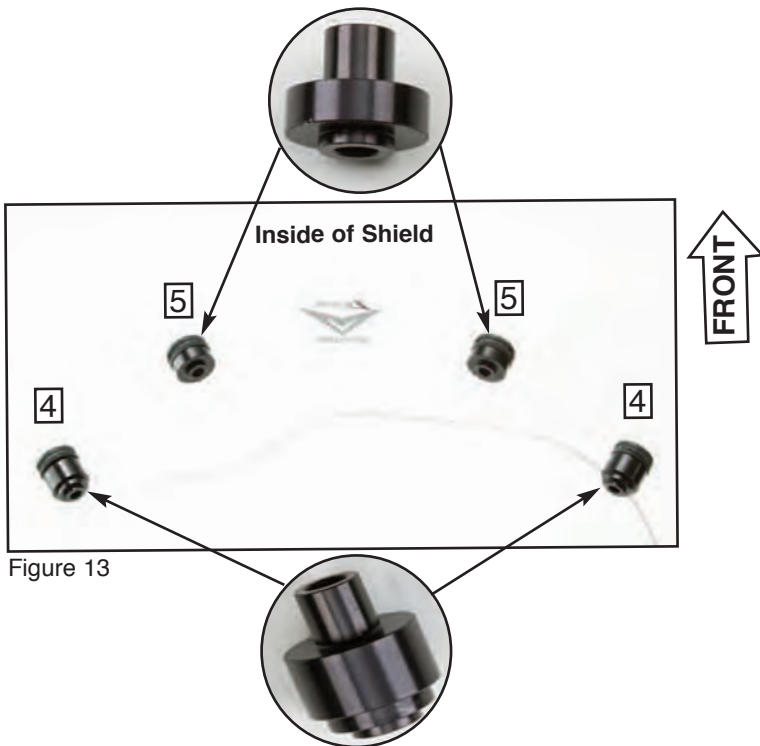

Figure 13

9. Hold Windshield with two hands, spring Side Deflectors apart while placing windshield into position. **Figure 14**



Figure 14

## OUTER MOUNT LOCATIONS, A



Figure 15

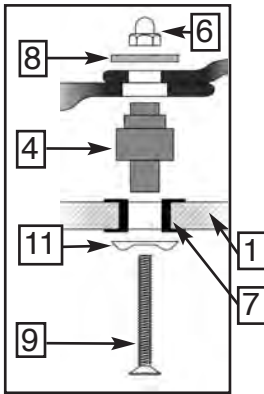

Diagram c

## INSTALLATION

### Install Windshield to Motorcycle

10. Start at the outer mount locations (A) and install windscreen using screw assembly as shown in figure 15 and diagram c. **Do not fully tighten at this time.** (5mm Hex Wrench, Closed Box Wrench) Figure 15, Diagram c

## INNER MOUNT LOCATIONS, B

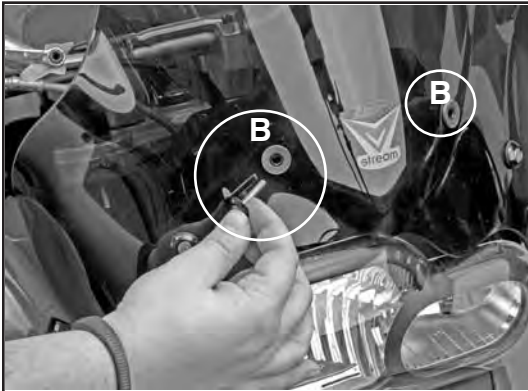

Figure 16

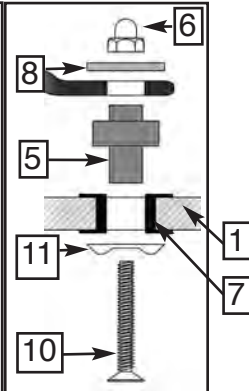

Diagram d

11. Install windscreen at the inner mount (B) locations using the screw assembly as shown in figure 16 and diagram d. **Do not fully tighten at this time.** (5mm Hex Wrench, Closed Box Wrench) Figure 16, Diagram d

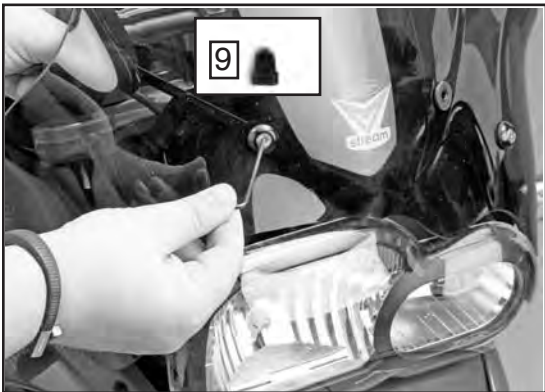

Figure 17

12. **Firmly tighten** the 4 screw assemblies. Figure 17 and 18 (5mm Hex Wrench, Closed Box Wrench)

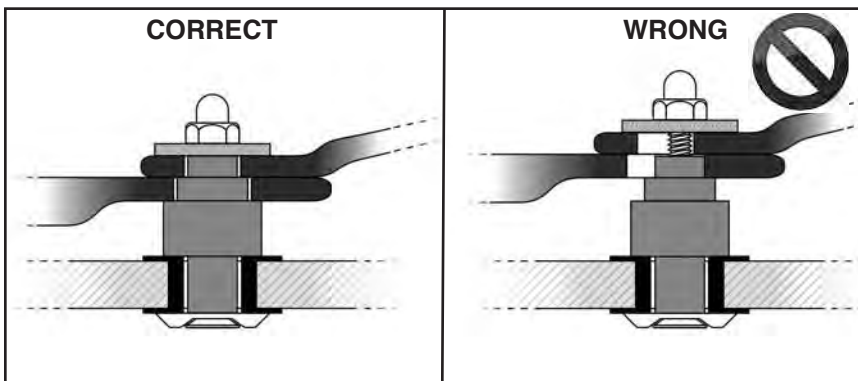

Figure 18

**⚠ The Outer and Inner Bushings must be fully seated in frame to tighten assembly correctly. Figure 18**



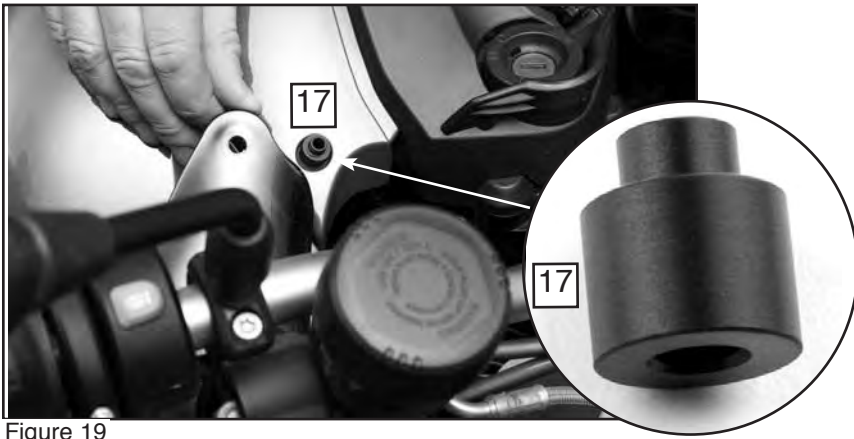

Figure 19

## INSTALLATION

### Secure Side Deflector to Tank

**13.** Place the Support Bushings (17), with narrow end up, in the two empty holes on the Tank Cover. **Figure 19**

**14.** Secure with Washer (15) and Screw (14). **Do not fully tighten at this time. Figure 20 (5mm Hex Wrench)**

**15.** Adjust Brackets (18 and 19) to line up with holes in Side Deflector. Install Side Deflector to Brackets with Screw (13), Washer (15) and Captive Nut (16) **Fully Tighten. Figure 21 (5mm Hex Wrench)**

### Final Adjustment

**16.** Adjust Windshield. Fully Tighten remaining fasteners as follows:

**Two, 40mm Screws (14) on tank cover (5mm Hex Wrench)**

**The two BMW Binding Head Screws (46 637 653 066) holding Brackets (18 and 19) Panel. (T25 Torx)**



Figure 20

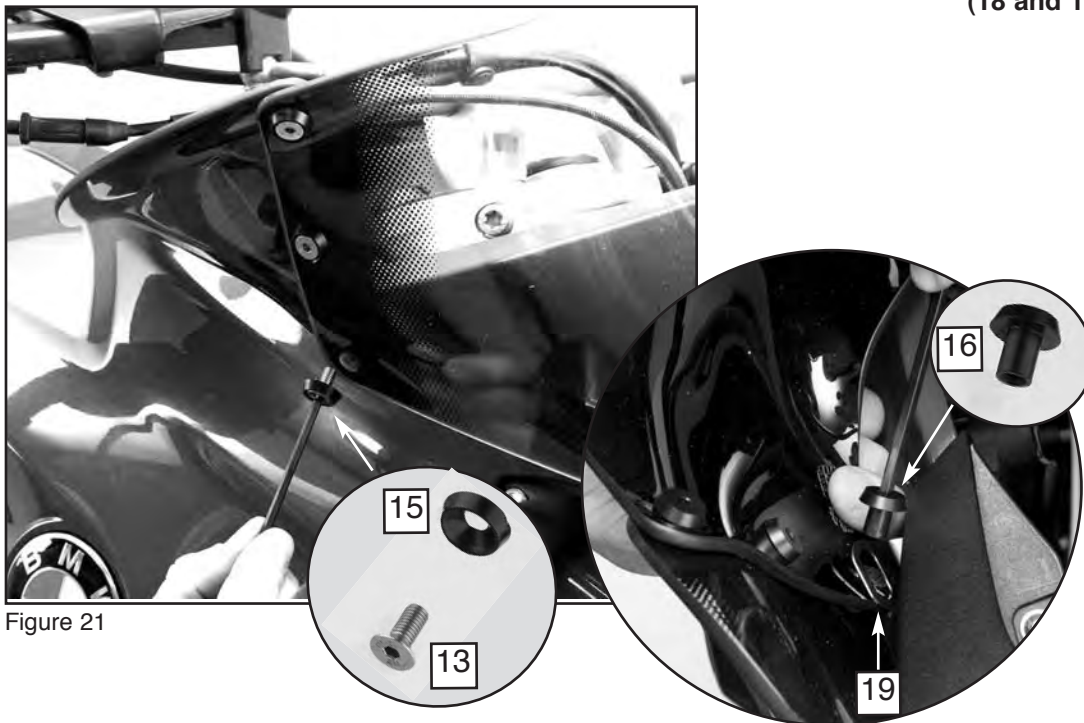

Figure 21

ZTechnik PO Box 158 Maywood, IL 60153-0158 USA

708-343-0400 / Fax: 708-343-0625 / www.ztechnik.com / e-mail: info@ztechnik.com