

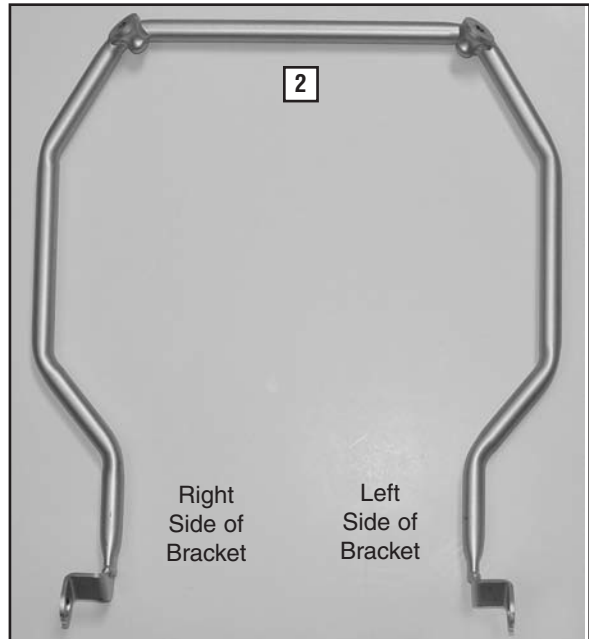

Thank you for purchasing a National Cycle® product. Please read these instructions carefully and thoroughly before beginning work. Dealers if installing this windshield for a customer please give them this manual. It contains information needed to properly maintain and use this product.

Attention Special notes and cautionary measures which can prevent damage to the accessory or motorcycle.

Note Tips for facilitation of operation, control and adjustment, as well as maintenance.

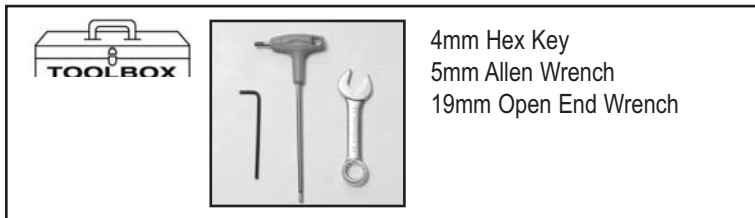

The Left and Right side of motorcycle is determined while sitting on the bike.

PARTS LIST

Item	Description	Qty.
Z2422 and Z2423		
1	Windscreen, Hardcoated Polycarbonate	1
2	34-365004-000 Bracket	1
BAG #1023		
3	51-514227-000 Screw, M6 x 25	2
4	34-346037-000 Cap	2
5	49-495669-000 Bushing	2
6	44-447304-000 Grommet	2
7	44-447304-000 Tie Wrap (not shown)	2

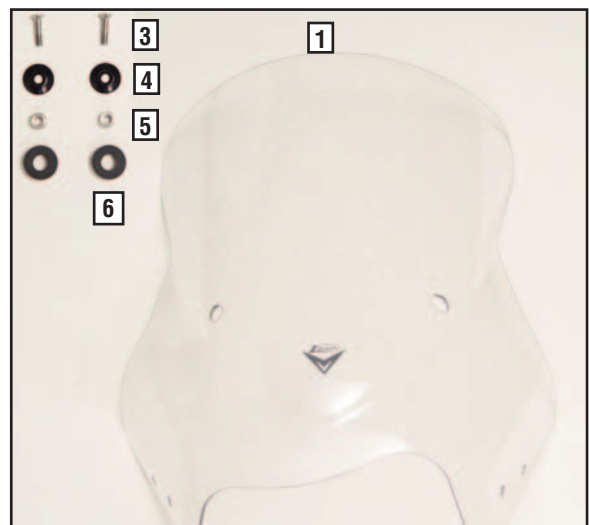

PREPARATION and REMOVAL OF PARTS

1. Position the motorcycle securely on center stand.
2. Remove the stock windshield. Remove the stock windshield bracket.
3. Retain stock lower covers and screws. This hardware will be re-used. **Figure 1**



Figure 1

INSTALLATION

**Install the bracket to the motorcycle.
Start on the right side of the motorcycle.**

1. Inside the upper right body panel on the inside of the motorcycle, locate the turn signal stalk. Remove the nut and washer holding the stalk. **(19mm Wrench) Figure 2**

You may need to cut the cable tie around the electrical  wires to access the nut. **(Cutters) Figure 2**

2. Position the forked arm of bracket onto the turn signal stalk. Replace washer and nut. **(19mm Wrench) Figure 3 and 4**

3. Repeat procedure on opposite side of motorcycle.

4. Tighten nuts until snug. Do not fully tighten at this time. **(19mm Wrench)**



Figure 2



Figure 3



Figure 4



Figure 5

Install the VStream® Windshield to the bracket

1. Install Grommets into each top hole on windshield.

Figure 6

2. Expand the sides of the windshield and place lower mount holes over the original equipment windshield mount points.

Figure 7

3. Insert one Bushing into each Grommet. **Figure 8**

4. Insert a Flat Screw through the Cap and install into upper mount hole on windshield. Repeat on opposite side. Leave hardware loose. **(4mm Hex Key) Figure 9**

5. Reinstall the lower mount covers on right and left side. **(5mm Allen Wrench) Figure 10**

6. Firmly tighten all hardware in the following order: Shield mount points, lower and upper and last frame at turn signal stalk.

MAINTENANCE

To clean the screen, wash with a clean soft cloth, plenty of warm water and if necessary, a non-abrasive soap such as dishwashing liquid. Flannel or soft chamois make good cleaning cloths. **Paint, glue residue or grease removal:** Moisten cotton with Naphtha or Turpentine followed by a wash as above. National Cycle Shield Wash™ makes a good daily cleaner and comes with a handy travel size bottle. N1401 Shield Wash is safe for helmet visors.

Do not clean polycarbonate in hot sun or high temperatures. Do not clean the screen with glass cleaners. Do not use rain protective products on the screen other than National Cycle brand Rain Zip® (Part No. N1410). Do not allow brake fluid, alcohol, or strong solvents to contact the screen.



Figure 6



Figure 7



Figure 8

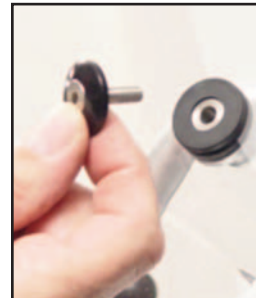

Figure 9

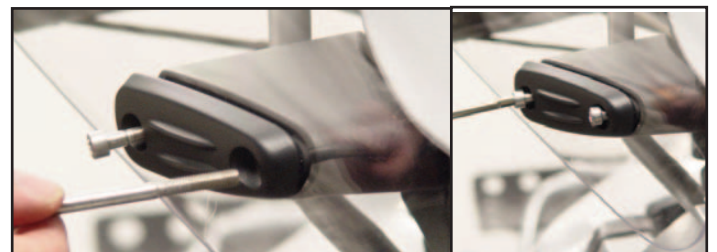

Figure 10

WARNING

Never ride your motorcycle with loose accessory mounting hardware. Check the hardware for tightness regularly.

Today's motorcycles are built with enough frame rigidity to withstand the moderate loads imposed on them by the foreseeable addition of an accessory(ies). If an accessory(ies) adversely affects your motorcycle's stability, immediately remove the accessory(ies). Do not ride a motorcycle that exhibits unsafe handling traits.

Have experienced service personnel correct any problem before riding with the accessory(ies) installed. For further questions concerning handling problems associated with an accessory(ies), contact your dealer, motorcycle manufacturer, or accessory manufacturer.



ZTechnik 3-Year Limited Warranty

Register your windshield on Line at: www.ZTechnik.com

ZTechnik hereby warrants to the original registered owner of a ZTechnik polycarbonate windshield for a period of three years from the date of purchase against breakage. This limited warranty is expressly limited to the replacement of the polycarbonate windscreen. This limited warranty does not include scratches, coating failure, cosmetic wear and tear, replacement of hardware, or any consequential damages or expenses including labor cost of installation, removal and/or replacement, inconvenience, inbound freight expenses or damage to any other component of the motorcycle or any other accessories. Certain chemicals, generally known as acidic hydrocarbons, are known to cause polycarbonate damage and will not be covered under this limited warranty. Please refer to the cleaning instructions supplied with all ZTechnik windshields.

Visit www.ZTechnik.com for further details or call or write ZTechnik / PO Box 158 / Maywood, IL 60153 / 708-3430400