

SPECIAL NOTE: Dealers, if installing the windscreen for a customer please give him this manual. It contains the instructional and reference material needed to properly maintain and use this product. This manual is designed for complete product knowledge. Take the time to become very familiar with your windscreen and its hardware to obtain the best results in use.

IMPORTANT: Please report any missing parts to your dealer or directly to National Cycle. The following information is necessary. BAG and SERIAL NUMBERS located on the outside of plastic bag and PLACE OF PURCHASE.

PARTS LIST

<u>Index</u>	<u>Part No.</u>	<u>Description</u>	<u>Qty.</u>
1	37-370010-CNL	Bracket, Left with decal	1
2	37-370011-CNR	Bracket, Right with decal	1
3	37-370010-000	Bracket, Inner	2
Bag 489			
4	37-410504-000	Bracket, Flat	2
5	42-483000-000	Nut, Hex Cap	4
6	42-433030-000	Nut, Whizlok	4
7	51-516317-000	Screw, Button M6 x 16	4
8	51-516313-000	Screw, Button M6 x 12	4
9	51-516450-000	Screw, Button M8-1.25 x 50	4
10	49-495535-000	Spacer, 1.18 L	4
11	49-495573-000	Spacer, 1.0 L	4

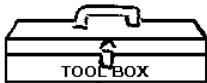
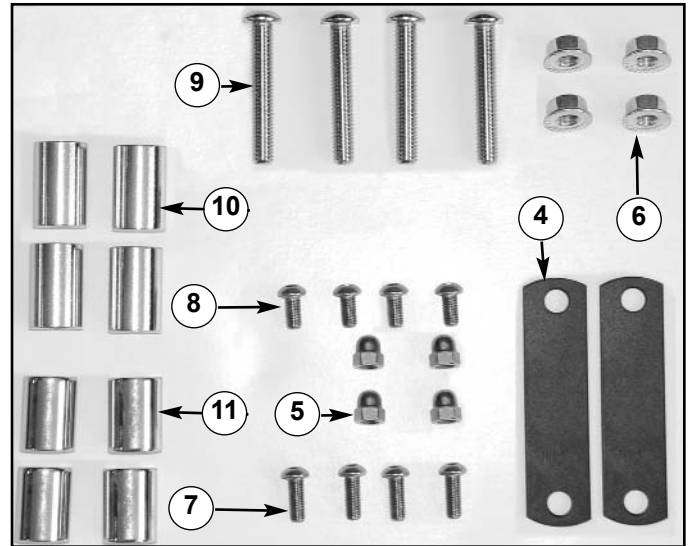

5mm and 4mm Hex Key Wrench
10mm and 13 mm Open End Wrenches

To adjust window of Heavy Duty Windshield if necessary.
Screwdriver, Phillips

PREPARATION

Place the motorcycle securely on its stand. Cover the fender and fuel tank to avoid scratches.

INSTALLATION without Chrome Lower

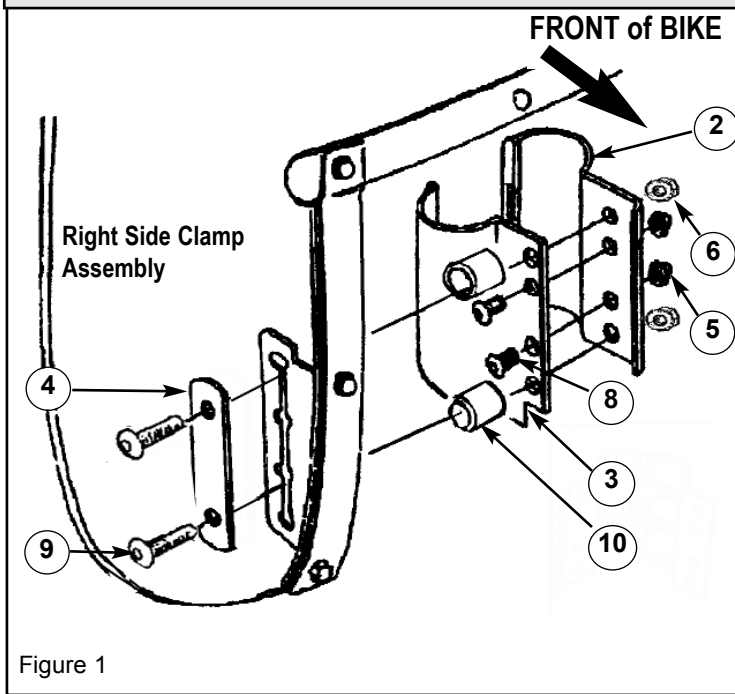

INSTALLATION with Chrome Lower

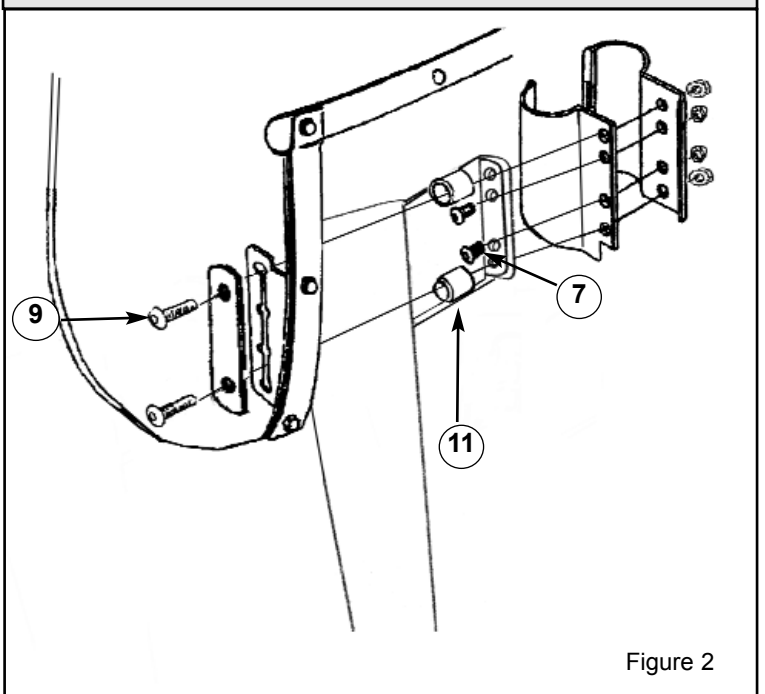

Figure 1

Figure 2

INSTALLATION PROCEDURE

1. Place outside bracket with decal onto fork. Hook inside bracket slots over outside bracket tabs.

Figure 1.

Installation of windshield without Chrome Lower

2. Place M6 x 12 socket head screw through holes in outside fork bracket. Hand tighten with cap nut. **Figure 1.**

Installation of windshield with Chrome Lower

2a. Place the Chrome Lower in position against the fork bracket. Use the M6 x 16 socket head screw to secure the Lower to the fork bracket. Hand tighten with cap nut.

Figure 2.

3. Repeat procedure for other side.

4. Adjust brackets to locate them just under the upper triple clamp. Keep in mind exact location will be determined by your final adjustment of the window to the height you prefer.

Installation of windshield without Chrome Lower

5. Install windshield onto brackets with flat plate, M8- 1.25 x 50 screw and 1.18" spacer as shown in **figure 1.**

Installation of windshield with Chrome Lower

5a. When installing with chrome lower, use a 1" spacer as shown in **figure 2.**

Note: At this time check height of windshield. The higher you raise the windshield, the lower you will adjust the window. Refer to "Adjusting Window".

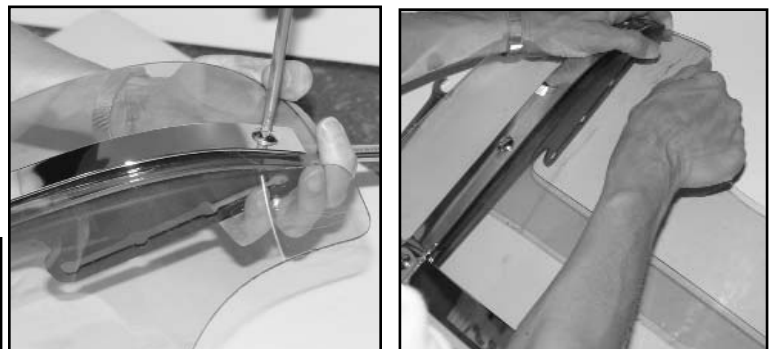

Figure 3

6. Make final adjustments. Check symmetry of left and right sides. Fully tighten socket head screws, bolts, and cap nuts.

ADJUSTING WINDOW **Figure 3**

The window is easily adjusted. Loosen the 6 cap nuts on the vertical chrome strips. Replace or adjust window. Tighten cap nuts to 2-4 ft.lbs (2.7-5.4 Nm), torque pressure.

Warning / Maintenance

National cycle windshields and fairings are designed to provide wind protection and increased riding comfort, but not protection in the event of a collision with another vehicle, the road, birds, or any other object.

Our products utilize certain features, patented and otherwise, that may minimize injury in certain accidents, but the possibility of injury exists if the screen is broken or if impacted by an object.

Always wear eye protection, helmets and protective clothing. Never ride your motorcycle while under the influence of drugs or alcohol.

All of our products are made in conformance and exceed the requirements of ABE, DOT, SS205,Z26.1, classifications AS6 and AS7, which covers all safety glazing for motorcycle application.

Never ride your motorcycle with loose windshield mounting hardware. Check the hardware for tightness regularly.

Today's motorcycles are built with enough frame rigidity to withstand the moderate loads imposed on them by the foreseeable addition of a fork mounted windshield.

If the addition of an accessory(ies) adversely affects your motorcycle's stability, immediately remove the accessory(ies). Do not ride a motorcycle that exhibits unsafe handling traits. Have experienced service personnel correct any problem before riding with the accessory(ies) installed. For further questions concerning handling problems associated with an accessory(ies), contact your dealer, motorcycle manufacturer, or accessory manufacturer.

MAINTENANCE

To clean the screen, wash with a clean soft cloth, plenty of warm water and, if necessary, a non-abrasive soap such as dishwashing liquid. Flannel or soft chamois make good cleaning cloths. Paint, glue residue or grease removal: Moisten cotton with Naptha or Turpentine followed by a wash as above.

Apply a high quality plastic polish, such as McGuir's Mirror-Glaze MGH-17 or Novus #2, to the clean screen. This will leave a protective coating in the screen making future cleanings easier. Do not clean polycarbonate in hot sun or high temperatures.

Do not clean the screen with glass cleaners. Do not use rain protective products on the screen. The solvent action of the alcohol in these products will destroy the screen. Do not allow brake fluid, alcohol, or strong solvents to contact the screen or penetrate between the chrome brackets and the polycarbonate. Permanent damage will result!

To remove scratches, use a very soft clean cloth and a fine grade buffing compound. Jewelers rouge or McGuir's Mirror-Glaze MGH-10 are best for this type of buffing. We recommend hand buffing.

STORAGE

Do not use low quality vinyl covers or old shower curtains to store your motorcycle or windshield. These products damage the plastic of windshields and the motorcycle body.