

**PARTS LIST**

<u>Index</u>	<u>Description</u>	<u>Part No.</u>	<u>Qty.</u>
1	Shield, Hand Deflector	20-231004-000	2
2	Plate, Outside	37-370900-000	2
3	Nut, 1/4-20 Acorn	42-480000-000	4
4	Screw, 1/4-20 x 1/2, Nylon	50-530500-000	4
5	Bracket, Left	37-370904-000	1
6	Bracket, Right	37-370902-000	1
7	Washer, 3/8" Int. Lock	49-492310-000	2

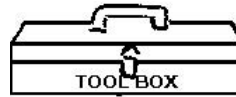

Wrench, 17mm  
Wrench, 7/16"  
Screwdriver, 3/8" Flat

**NOTE:** Left and right side of motorcycle are determined from rider's perspective while sitting on motorcycle.

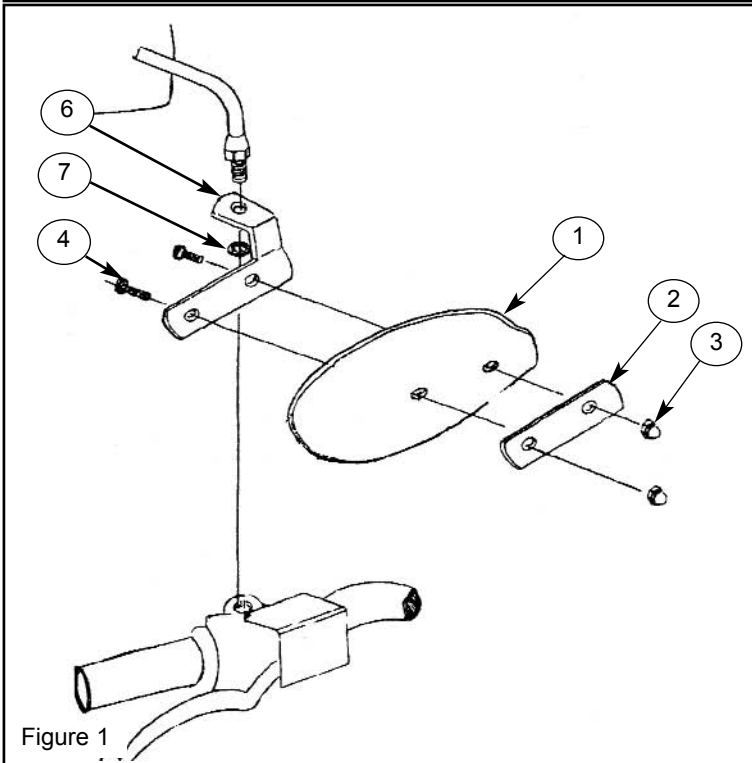
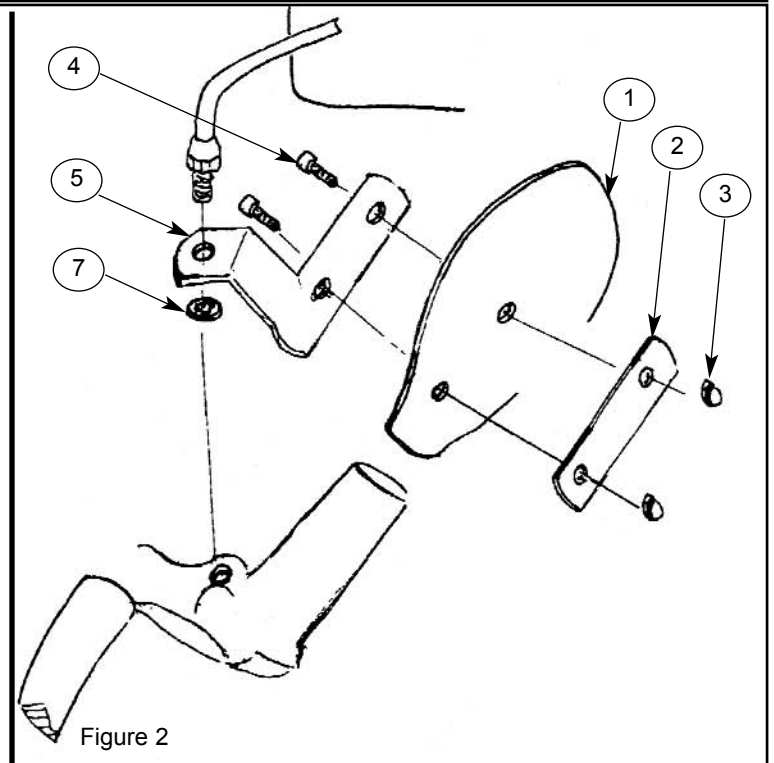
**RIGHT SIDE OF MOTORCYCLE HAND DEFLECTOR ASSEMBLY**

**LEFT SIDE OF MOTORCYCLE HAND DEFLECTOR ASSEMBLY**

**PREPARATION**

Assemble the Hand Deflector plastic to the Right and Left brackets as shown in Figure 1 and 2. Note, screws are inserted through the bracket from the **INSIDE** of the plastic. Place the outside plate (2) over the screws (4) and add the nuts (3). Tighten until snug, do not over tighten.

**INSTALLATION**

Remove the right mirror, (Wrench, 17mm).

Position a lock washer (7) so it is between the mirror mount and the Hand Deflector bracket (6).

Position the right Hand Deflector assembly onto the mirror mount.

 **Check clearance of Hand Deflector to gas tank by turning handlebar to a full lock left and right. If necessary adjust Hand Deflector by rotating bracket (5) or (6) until plastic does not contact gas tank.**

Install the mirror, check clearance, adjust, then tighten the mirror nut to 1.8 m-kG (13 ft lbs.) torque.

Repeat the above procedure for the left side.

**MAINTENANCE** To clean the plastic, wash with a clean soft cloth, plenty of warm water and, if necessary, a non-abrasive soap such as dish washing liquid. Flannel or soft chamois make good cleaning cloths. Paint, glue residue or grease removal: Moisten cotton with Naphtha or Turpentine followed by a wash as above.